

QSS-FW100-PP-01

Cable Penetrating a flexible or rigid wall (100mm or thicker)



This standard detail is intended for general information only and all details should be checked against all relevant supporting test evidence, certification and installation guidelines. In line with the company's policy of continual development, details are subject to change and/ or withdrawal therefore you must ensure this is the latest published detail and instructions.

Additional Instructions

Flexible walls can be insulated or uninsulated and must have a minimum 50mm wide stud and minimum 2no. layer of 12.5mm Gypsum boards in accordance with EN 520 or Calcium Silicate boards which are CE Marked based on an ETA, on both sides of the stud.

Although some details have the allowance for large maximum apertures, the practicality of the installation needs to be considered.

Test results obtained with flexible supporting walls may be applied to concrete or masonry elements of an overall thickness equal to or greater than that of the element used in the test.

BS EN 1366-3:2021 Section 13.7: The distance between the aperture edges of penetration seals in a building element shall be as tested or minimum 100mm. The distance between the aperture edge of a penetration seal and any other penetration (e.g., door) in a building element shall be minimum 200mm.

*** Cable Bundle**

Multiple ≤21mm cables can be installed into an aperture 100mm wide x 45mm high. Cables must be positioned in a linear row and can be 0mm from one edge but must be a minimum 10mm distance from all other edges of the aperture. QuelStop Acrylic Sealant is then installed to a minimum 25mm depth around the cable bundle.

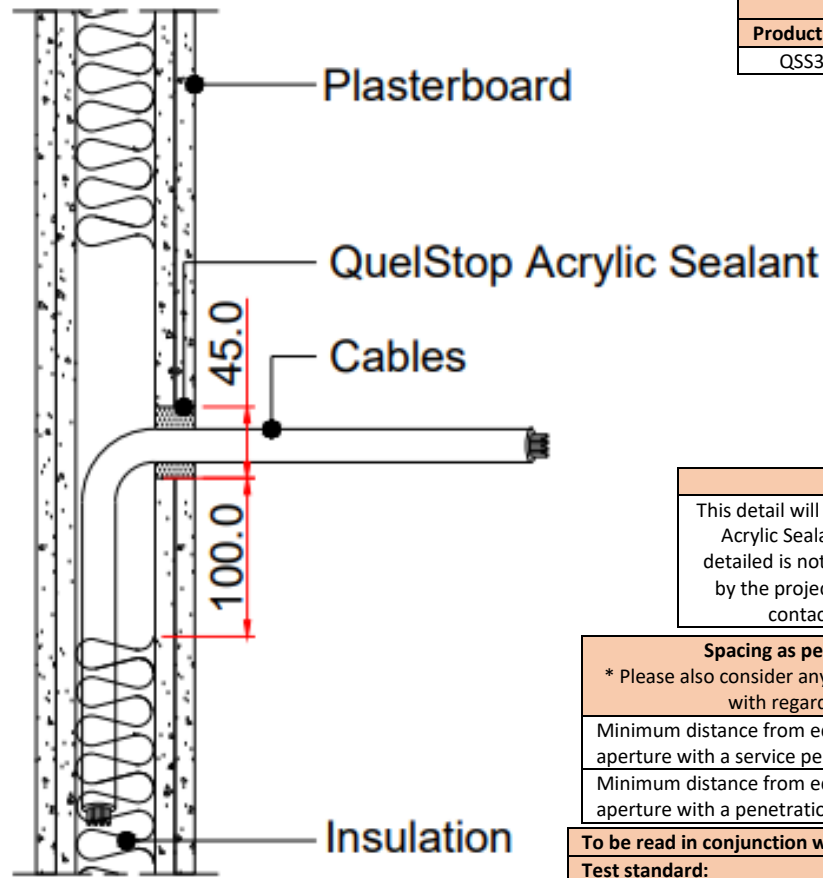
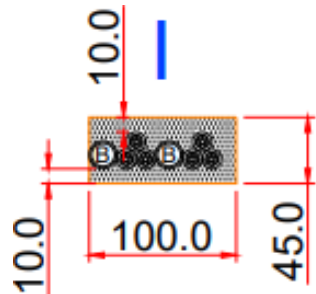

Quelfire Products Required	
Product Code	Description
QSS310	QuelStop Intumescent Acrylic Sealant

**** Test Evidence**

This detail will be included in a future update of the QuelStop Acrylic Sealant Classification Report. The fire test report detailed is not for general distribution but can be requested by the project's qualified fire consultant/ engineer if they contact the Quelfire Technical Team directly.

Spacing as per BS EN 1366-3: 2021, Section 13.7

* Please also consider any requirements that the wall manufacturer has with regards to spacing between openings.

Minimum distance from edge of opening to another aperture with a service penetration tested to BS EN 1366-3	100mm*
Minimum distance from edge of opening to another aperture with a penetration <u>not</u> tested to BS EN 1366-3	200mm*

To be read in conjunction with:	WF 542146C/R Specimens I & J**
Test standard:	BS EN1366-3
Substrate minimum thickness:	100mm
First Service Support:	≤400mm
Drawing Scale:	Not to Scale
Issue Number:	1
Date of Issue:	March 2025
Detail Reference:	QSS-FW100-PP-01

Service Type	Size of services	QuelStop Acrylic Sealant (Installed both sides of the wall)	Backing Material	Fire Rating
Cable	≤∅21mm	≤10mm Annulus Minimum 25mm Depth	N/A	120 minutes Integrity 120 minutes Insulation

Important Information:

- The supporting construction must be installed in accordance with the manufacturer's guidelines and must be capable of achieving the required fire rating of the firestop.
- All services should be adequately supported on both sides of the firestop to ensure that no load is transferred onto the firestop seal.

Scope and Liability:

- Any Information provided by or on behalf of Quelfire Limited is provided for general information only. It is not intended to amount to advice on which you should rely. You must obtain professional or specialist advice before taking, or refraining from, any recommendation or action.
- The summary is not exhaustive and does not consider all issues relevant to the enquiry. It is limited to the information and time available to us. We have not verified any information made available to us by you or any other source, nor have we carried out a physical inspection of any property. We make no representations, warranties or guarantees, whether expressed or implied, that any information is accurate, complete or up to date.
- We do not accept a duty of care to you or any other person in respect of the enquiry, nor do we accept any liability to you or any other person for any loss arising out of or in connection with the enquiry or any reply provided by us. Different limitations and exclusions of liability arising as a result of the supply of any products or services by us to you, and these will be set out in our terms and conditions of supply, a copy of which is available on request.
- Full terms and conditions of sale are available at <https://www.quelfire.co.uk/terms-conditions-of-sale/>