

QRS-FW130-04

Plastic vent duct penetrating an external wall

This standard detail is intended for general information only and all details should be checked against all relevant supporting test evidence, certification and installation guidelines. In line with the company's policy of continual development, details are subject to change and/ or withdrawal therefore you must ensure this is the latest published detail and instructions.

Additional Instructions

This is an indicative detail only of how the QRS might be considered in an external wall application.

Its suitability needs to be checked with a qualified fire engineer who would need to consider the fire rating of the boards to which it penetrates and the overall supporting construction in conjunction with our primary test evidence for the QRS in a standard flexible wall as set out in detail [QRS-FW130-01](#).

Where the QRS is intended to be used in conjunction with non-combustible ducts in the cavity, any questions surrounding the suitability and application need to be directed to a qualified fire engineer rather than Quelfire as it will be outside the scope of any test evidence.

The fire rated board construction should be cut as tight as possible around the QRS Fire Sleeve.

The QRS should be fitted so that it is centrally positioned and protruding or at least flush with the outside of the face of both sides of the wall.

Once finally positioned, the small gap around the QRS, which should not exceed 5mm, should be sealed with QuelStop Intumescent Sealant.

Where the gap exceeds this, it should be replaced in accordance with the board manufacturer's recommendations.

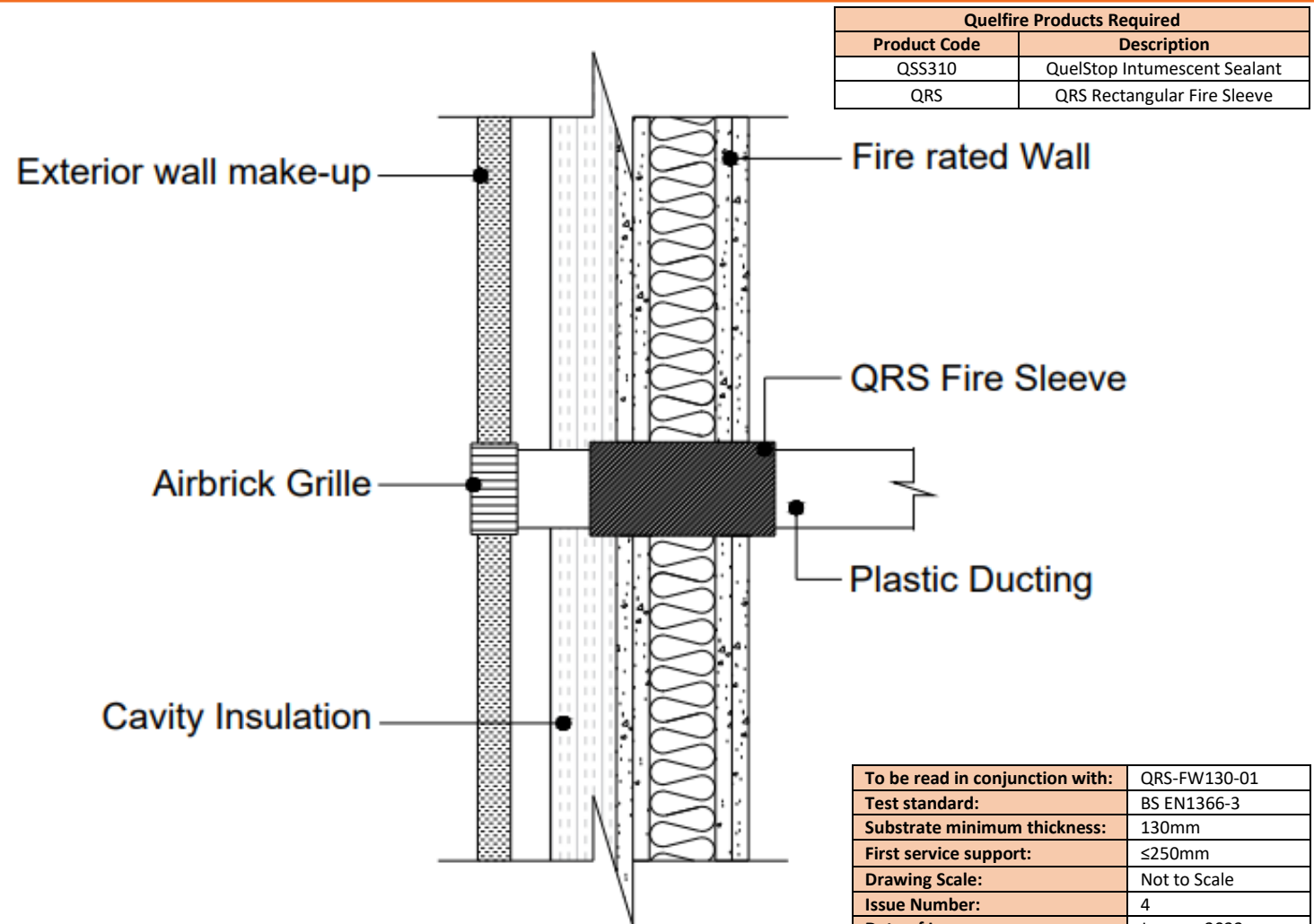

Quelfire Products Required

Product Code	Description
QSS310	QuelStop Intumescent Sealant
QRS	QRS Rectangular Fire Sleeve

To be read in conjunction with:	QRS-FW130-01
Test standard:	BS EN1366-3
Substrate minimum thickness:	130mm
First service support:	≤250mm
Drawing Scale:	Not to Scale
Issue Number:	4
Date of Issue:	January 2023
Detail Reference:	QRS-FW130-04

Important Information:

1. The supporting construction must be installed in accordance with the manufacturer's guidelines and must be capable of achieving the required fire rating of the firestop.
2. All Services should be adequately supported either side of the firestop to ensure that no load is transferred onto the firestop seal.

Scope and Liability:

1. Any Information provided by or on behalf of Quelfire Limited is provided for general information only. It is not intended to amount to advice on which you should rely. You must obtain professional or specialist advice before taking, or refraining from, any recommendation or action.
2. The summary is not exhaustive and does not consider all issues relevant to the enquiry. It is limited to the information and time available to us. We have not verified any information made available to us by you or any other source, nor have we carried out a physical inspection of any property. We make no representations, warranties or guarantees, whether expressed or implied, that any information is accurate, complete or up to date.
3. We do not accept a duty of care to you or any other person in respect of the enquiry, nor do we accept any liability to you or any other person for any loss arising out of or in connection with the enquiry or any reply provided by us. Different limitations and exclusions of liability arising as a result of the supply of any products or services by us to you, and these will be set out in our terms and conditions of supply, a copy of which is available on request.
4. Full terms and conditions of sale are available at <https://www.quelfire.co.uk/terms-conditions-of-sale/>